



**Marsha Reeves**  
**Painting Chickens**

*GWG Workshop - February 28, 2017*



Marsha Reeves had two Chicken Projects for us to work on. She had reference photos for everyone. She also mentioned that she uses the Murray McMurray catalog ([mcmurrayhatchery.com/800.456.3280](http://mcmurrayhatchery.com/800.456.3280)) which for reference for characteristics of different chickens. She broke each of the projects into small bites. She first had us trace her designs. She then demonstrated the technique and then we went back and tried it out for ourselves. For each project she used a red, yellow and blue. She did her color mixing on the page, rather than the palette. She said that you lose some of your control, but gain depth by letting those colors mix themselves on the paper. She mixed up big juicy puddles and applied the paint to dry paper. She encouraged us to use our brush to describe something rather than just filling up a space. We should play with our brushes by using them on the side, the tip and holding at the end of the handle.

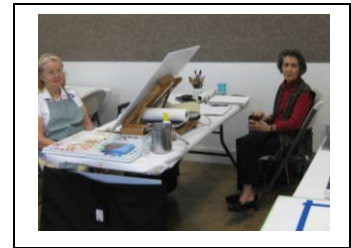

**Project One: Rooster**

**Step 1:** Marsha used a dark red (DaVinci Red or Winsor Red), a bright yellow (Winsor Yellow or Gamboge) and a deep blue (Pthalo-green shade or Prussian Blue). She began with applying yellow to the comb and wattles and then dropping in red over that yellow. She was careful to plan on leaving the white for the highlight of the eye by painting around that area. She next put yellow in the area of the hackles and the wing. She dropped in several drops of red and then blew on it to create feathers.

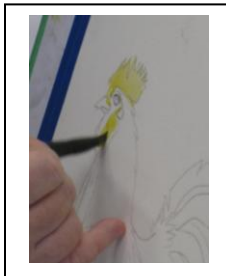

**Step 2:** Marsha used negative painting around the cape of the body. Using her large Silver Black Velvet 1" oval brush dipped in the deep blue and the dark red she created a dark which had variety and was not flat. She Used an "Oriental Sensibility" to determine her lights for the front and darks for the back. She dropped in water on the almost dry area feathered part of the legs to create "fuzzy britches" for the rooster. She added blue, red and yellow to make a gray for the beak which is not a bright yellow.



**Step 3:** Marsha misted the tail area by spraying up above the paper and letting the mist fall down onto the paper. She painted the tail with the blue and red. She dipped into both the blue and red. It dried substantially lighter. Later she came back in with a thicker blue and red to help the tail not look "wishy-washy." She also "beefed up" the comb with a stronger red, lifting some back out and dropping in yellow.

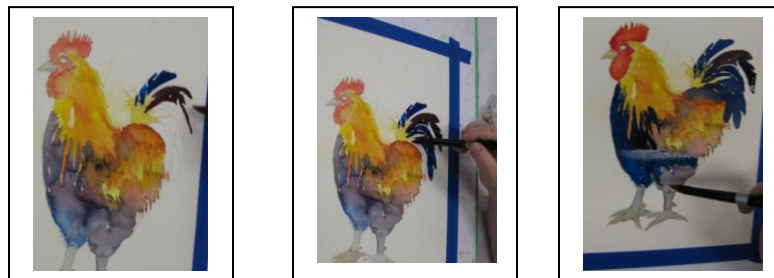

**Step 4:** Marsha added scales to the legs and continued darkening the chest area.

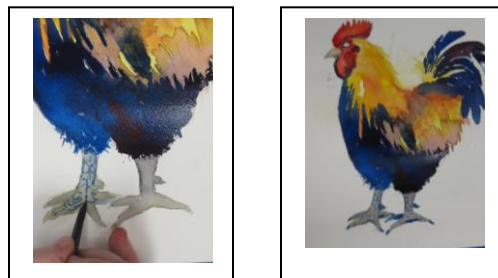

**Step 5:** Marsha wet the background with a juicy yellow. She dropped in drops of red and splashes of blue and let the paint mix on its own.



## Project Two: Chicks with Bracelets

**Step 1:** Marsha used French Ultramarine Blue, New Gamboge and Cadmium Red Deep for this project. She dropped in a base using those colors. She misted it and then tilted it and let it mix. She dropped in more background that turned green as she was doing negative painting around the chickens.

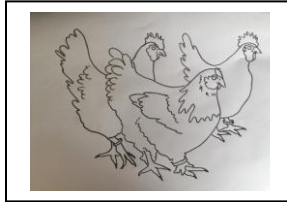

**Step 2:** Marsha added Cerulean and Hansa Yellow behind the chickens, painting anything that was not chickens. She varied it, making contrast with greens behind the red combs so that it would "pop." She used reds to suggest branches. She added reds to the shadow area under the chickens. She made sure to stick colors in other places around the painting for balance.



**Step 3:** Marsha painted the combs and beaks. She dropped in the blues and reds on the chickens to form the feather areas. She painted negatively behind the chicken in the front to push the other chickens back.

